



Quick Start Guide

Amicon® Stirred Cell

Caution: Not intended for medical purposes or for use in diagnostic procedures.

Before using the Amicon® Stirred Cell, please read the full-length user guide available at www.millipore.com/amiconstirredcell.

Amicon® Stirred Cell Components

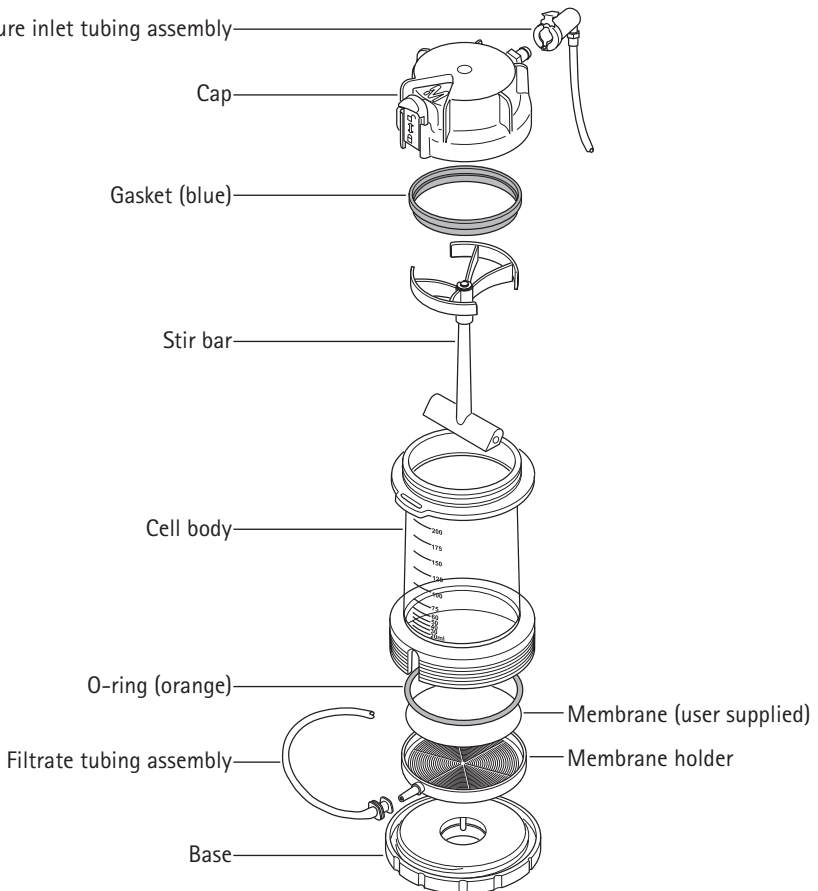

7. With cap oriented as shown, seat large diameter of gasket in gasket groove. Gently push the gasket down to seat it fully.

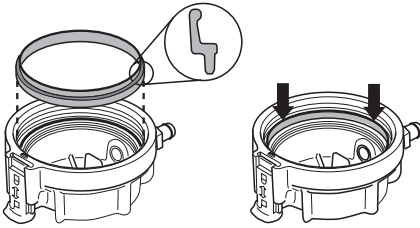

IMPORTANT! To avoid leakage between cap and cell body, make sure that the gasket is free of dirt/debris and oriented correctly in the cap.

8. Screw cap onto cell body until it stops.

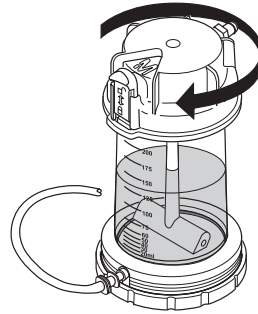

9. Move blue slide-lock downward to close pressure relief valve and lock cap in place.

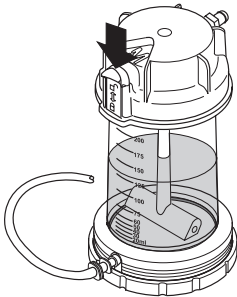

10. Attach pressure inlet tubing assembly by inserting female connector onto quick-connect fitting on cap until it clicks.

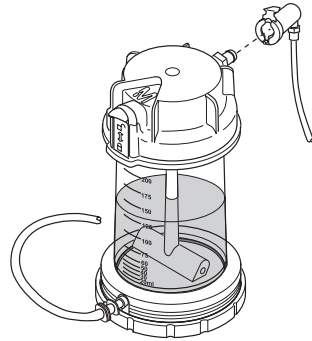

11. Place stirred cell on magnetic stirrer.
12. Insert filtrate tubing into an appropriate collection container.
13. To concentrate, connect free end of pressure inlet tubing to a pressure source.
14. Initiate stirring and pressurize stirred cell to desired pressure. Refer to membrane instructions for optimal operating pressures.

WARNING: Do not exceed pressure limit of 5 bar (75 psi).

15. Collect filtrate until desired concentration factor is achieved.

